

ITS THE SMALL THINGS IN LIFE THAT COUNT



Fx SERIES

Job		Specification	
Construction	Gardening & landscaping	Fencing, ground excavation, rock breaking	●
	Earthworks	Trenching, pit building, ground excavation	●
	Dredging	Canal deepening & extension Dock deepening & extension	●
	Tunnelling	Tunnel driving, roof, face & rib scaling Floor levelling	●
Demolition & renovation	Masonry structures	Brickwork, natural stone Autoclaved aerated concrete	●
	Concrete structures	Lightweight concrete Standard concrete	●
	Pavements	Asphalt, concrete, composite surfaces	●
	Composite steel & concrete structures	Steel-reinforced concrete, pre-stressed concrete, fibre-reinforced concrete	●
Mining & quarrying	Preliminary works	Overburden removal, bench, road & ramp levelling, roof, face & rib scaling	●
	Secondary breaking	Boulder reduction in rock pile, removing blockages at crushing systems	●
Metallurgical industry	Cleaning & de-bricking	Ladles, converter mouths, kilns	●
	Slag recycling	Boulder reduction in slag heap, removing blockages at crushing systems	●

● Optimal ● Suitable

THE REVOLUTION IN MINI EXCAVATORS

FEATURES & BENEFITS

- Mono-block design
- No through bolts
- Designed with replaceable cylinder liners for saving maintenance cost and downtime
- No diaphragm
- Field replaceable front bushing keeps rods in peak performance
- Extended front bushing for maximum service life (Fx45a/55a)
- Wide oil flow range for fast, hard-hitting performance and more carrier options
- A wide variety of working rods
- Rod pin for increased rod contact and double service life (Fx45a/55a)
- One strategically located warehouse facility with extensive rod inventories assuring on-time deliveries

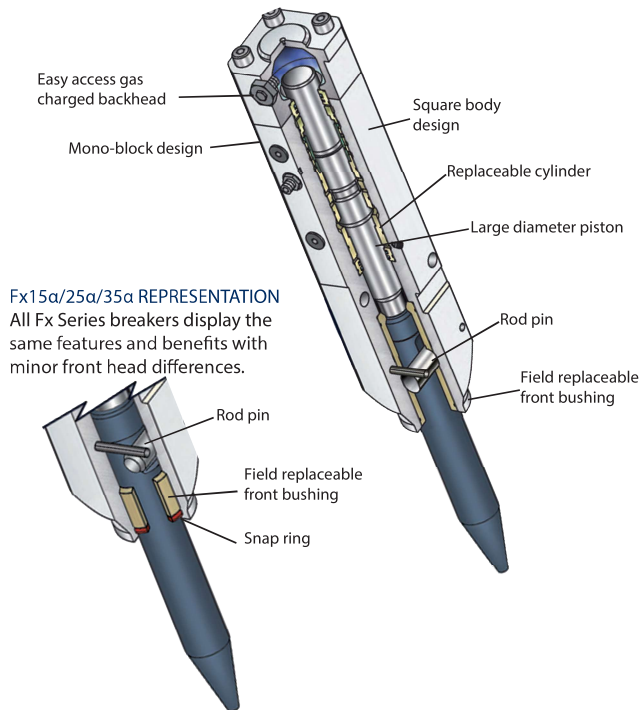

Fx15a/25a/35a REPRESENTATION

All Fx Series breakers display the same features and benefits with minor front head differences.

Fx15a/25a/35a

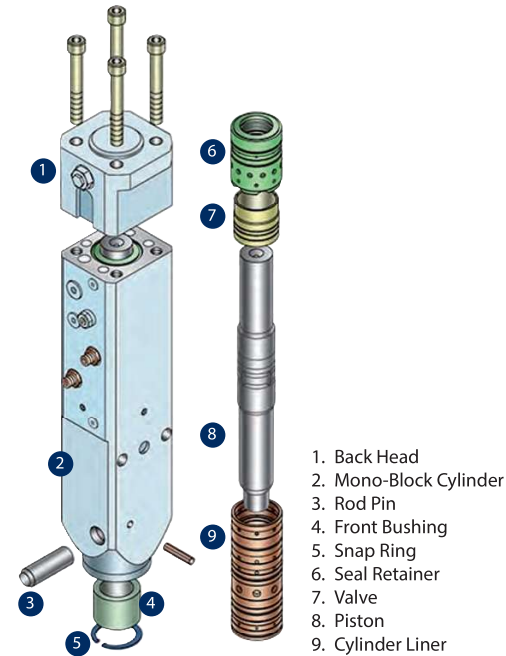

Fx45a/55a

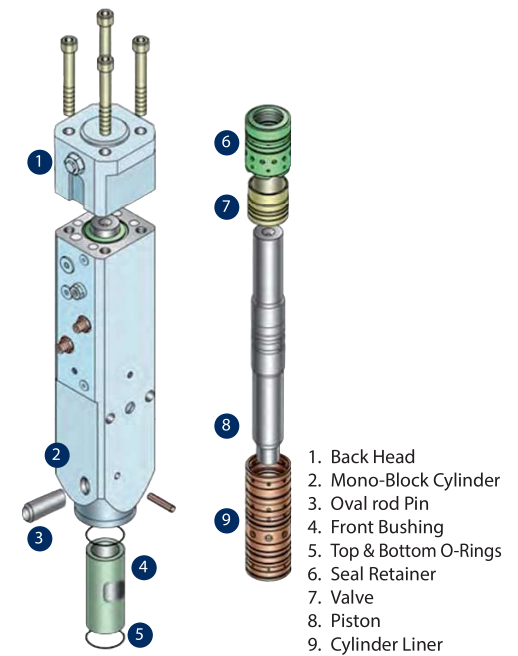

Fx SERIES

TYPE OF FRAMES

PIN AND BUSH



The easiest way to fix a hydraulic breaker on an excavator. Order the appropriate pin & bushing set and you can fix your hydraulic breaker on an excavator arm.

SILENCE



Noise reduction is required in the workplace and you have the beginning of the Silent part of our offered possibilities. The frame is up to 6 dB(A) quieter than the standard frame.

XTRA SILENCE











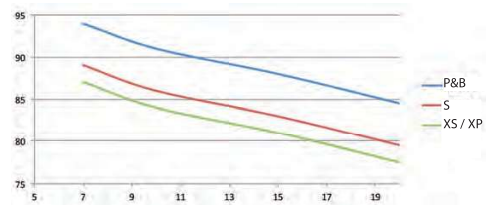





With the Xtra frame we currently offer the maximum in noise reduction. The optimal management of the hammer in the frame in conjunction with the patented design of the FRD rod gives up to 4 dB(A) noise reduction than the Silence version.

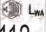

SOUND POWER & SOUND PRESSURE

These are two distinct and commonly confused characteristics of sound. Sound power is the acoustical energy emitted by the sound source, and is an absolute value. It is not affected by the environment. Sound pressure levels quantify in decibels the intensity of given sound sources. Sound pressure levels vary substantially with distance from the source, and also diminish as a result of intervening obstacles and barriers, air absorption, wind and other factors. Sound pressure is what our ears hear and what sound pressure level meters (SPL meters) measure.



Sound level	Fx15a	Fx25a	Fx35a	Fx45a	Fx55a
PIN & BUSH (PB)	 116 dB	 118 dB	 124 dB	 126 dB	 126 dB
SILENCE (S)	-	 112 dB	 119 dB	 120 dB	 119 dB
XTRA SILENCE (XS)	-	 110 dB	 117 dB	 117 dB	 116 dB

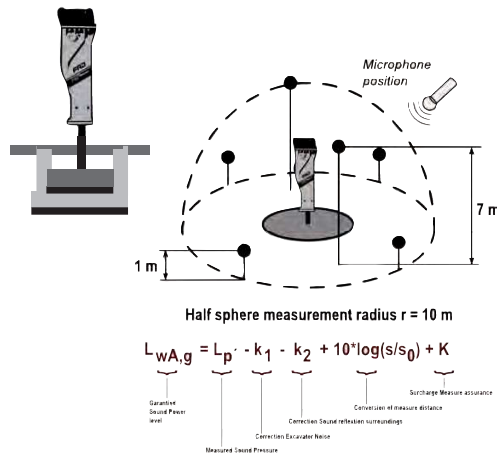

Fx SERIES

Fx15α



P&B



Fx45α



P&B S XS



Fx25α



P&B S XS



Fx55α



P&B S XS



Fx35α



P&B S XS



		Fx15α	Fx25α	Fx35α	Fx45α	Fx55α
Operating weight, P&B ¹⁾	kg	60	83	129	165	220
Operating weight, ¹⁾ S and XS ²⁾	kg		118	167	220	292
Height with rod, pin and bush	mm	924	1030	1172	1345	1388
Height with rod, S	mm		943	1042	1150	1248
Height with rod, XS	mm		993	1048	1138	1234
Operating pressure	min	MPa	10	10	12	12
	max		14	14	16	16
Oil flow	min	l/min	10	18	24	30
	max		28	35	52	60
Impact rate 1/min	min	bpm	600	600	600	500
	max		1500	1500	1300	1100
Rod diameter Ø	mm	36	45	52	60	68
Effective length Rod	mm	234	293	322	355	378
Weight Rod	kg	2.6	5	8	11	15
Hose inner dia Ø HD, ND	mm	9	12	12	12	12
Guaranteed noise level	S	dB(A)	112	119	120	119
	XS	dB(A)		110	117	116
Base machine weight	t	0.85 - 1.5	1.35 - 2.5	1.9 - 3.5	3.0 - 4.5	4.0 - 5.5

¹⁾ Operating weight with top bracket. ²⁾ S and XS Silent Version = Sound and vibration damping

Specifications subject to change without notice

Fx SERIES OVERVIEW